



G2

HEIGHT CALCULATOR

LUPIT POLE (CLASSIC & DIAMOND) G2 HEIGHT CALCULATOR					LUPIT POLE (CLASSIC & DIAMOND) G2 HEIGHT CALCULATOR				
BASIC KIT					BASIC KIT + EXTENSION				
ceiling height					ceiling height				
h	from 2300 mm to 2425 mm	from 2425 mm to 2550 mm	from 2550 mm to 2675 mm	from 2675 mm to 2800 mm	h	from 2800 mm to 2925 mm	from 2925 mm to 3050 mm	from 3050 mm to 3175 mm	from 3175 mm to 3300 mm
h	from 7' 6.55" to 7' 11.47"	from 7' 11.47" to 8' 4.39"	from 8' 4.39" to 8' 9.31"	from 8' 9.31" to 9' 2.24"	h	from 9' 2.24" to 9' 7.16"	from 9' 7.16" to 10' 0.08"	from 10' 0.08" to 10' 5.00"	from 10' 5.00" to 10' 9.92"
	A+B+E	A+B+D+E	A+B+C+E	A+B+C+D+E		A+B+F+E	A+B+F+D+E	A+B+F+C+E	A+B+F+C+D+E
ASSEMBLY PARTS - BASIC KIT					ASSEMBLY PARTS - BASIC KIT + EXTENSION				
					 Optional extension 1 x extra 500 mm / 1' 7.69" extensions for up to 3300 mm / 10' 9.92"				

PACKAGE AND CONTENTS

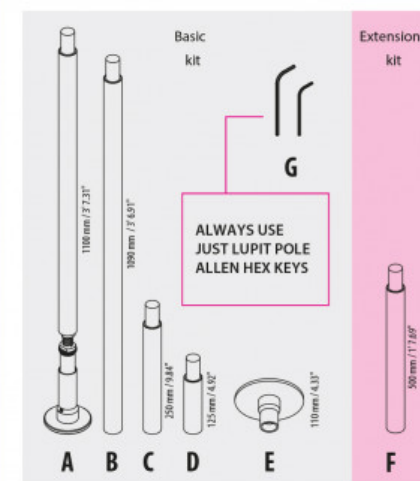

LUPIT POLE (CLASSIC & DIAMOND) **G2** (GENERATION 2)
COMES IN SINGLE PACKAGE:

- A.** Base pole (1100mm / 3' 7.31") with lower-disc bearing, distance-regulating system and spin-block system.
- B.** 1x 1090mm / 3' 6.91" main pole with integrated joints.
- C.** 1x 250mm / 9.84" pole extension with integrated joints.
- D.** 1x 125mm / 4.92" pole extension with integrated joints.
- E.** Upper-disc assembly with bearings.
- F.** 1x 500mm / 1' 7.69" pole extension with integrated joints. (optional – not included in a standard package)
- G.** 2 x Allen HEX key.

+ User's manual and assembling instructions.